



Disclaimer

The information in this overview was believed to be correct at the time of development. Changes since that time may have occurred that may make the information inaccurate.

Please check the latest GM service information for accurate repair procedures.

Collision Industry Conference – April 2004

GM

GTO

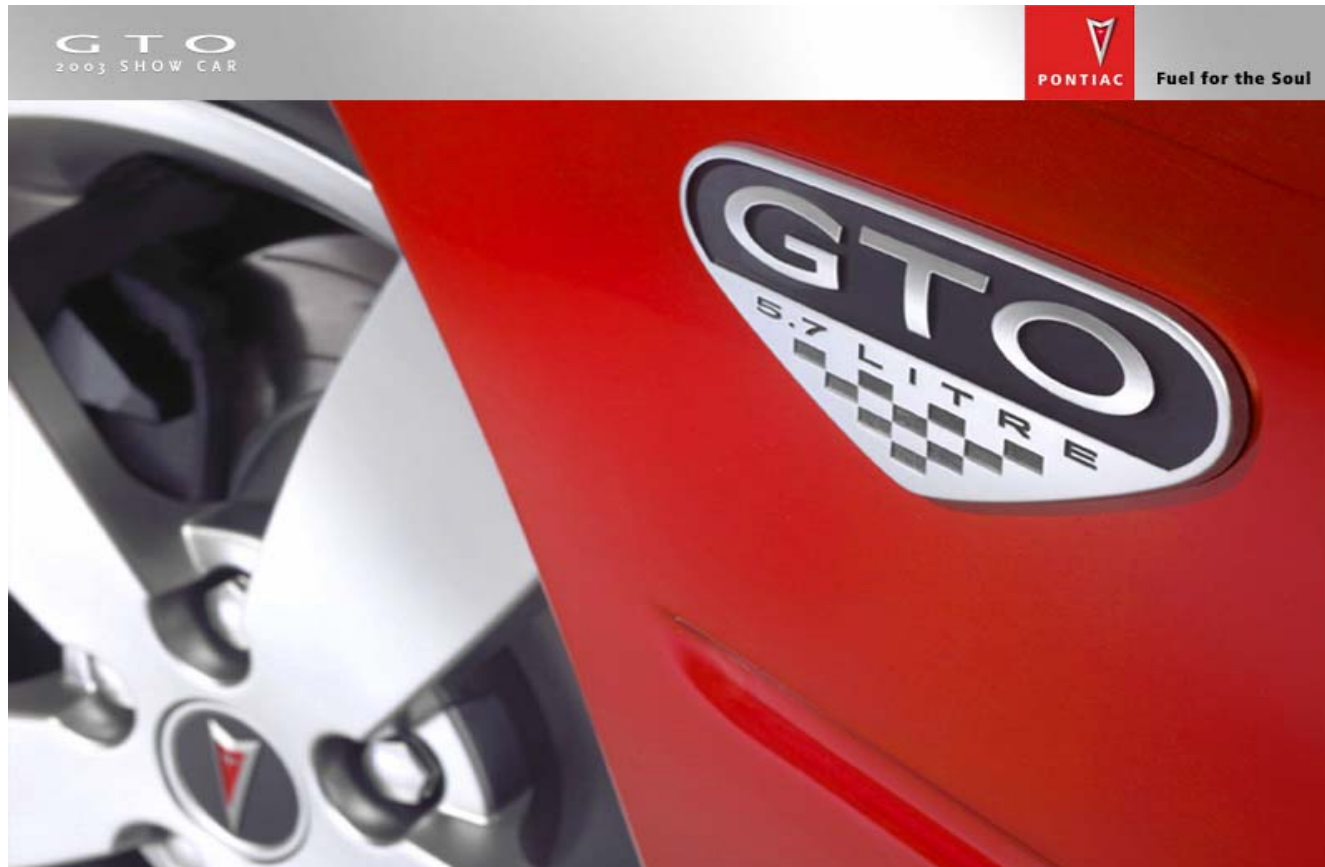

2004 PONTIAC GTO

*Presented by
Jack Aho*

Start of Production 9-13-03

GM

GTO Marketing Information:

Body Style(s):

2 Door Coupe

Size Classification:

Midsized Passenger Car

Model Replaced:

None (New Model)

Production Plants:

Elizabeth, Australia





GTO Vehicle Specifications:

- 5.7 L V-8
- Seating for 4
- Rear wheel drive

Wheelbase (in / mm):

109.8 / 2788

Overall Length (in / mm):

189.8 / 4821

Height (in / mm): Width (in / mm): Est. Curb Weight (lbs):

54.9 / 1397

72.5 / 1841

3700 - 3800





GTO Exterior Panel Identification:

- Exterior body panels are mild steel
- Two-sided galvanized steel
 - * *Except roof (1 side)*
- Bumper bars are HSS
 - * *Replace only, no repair*

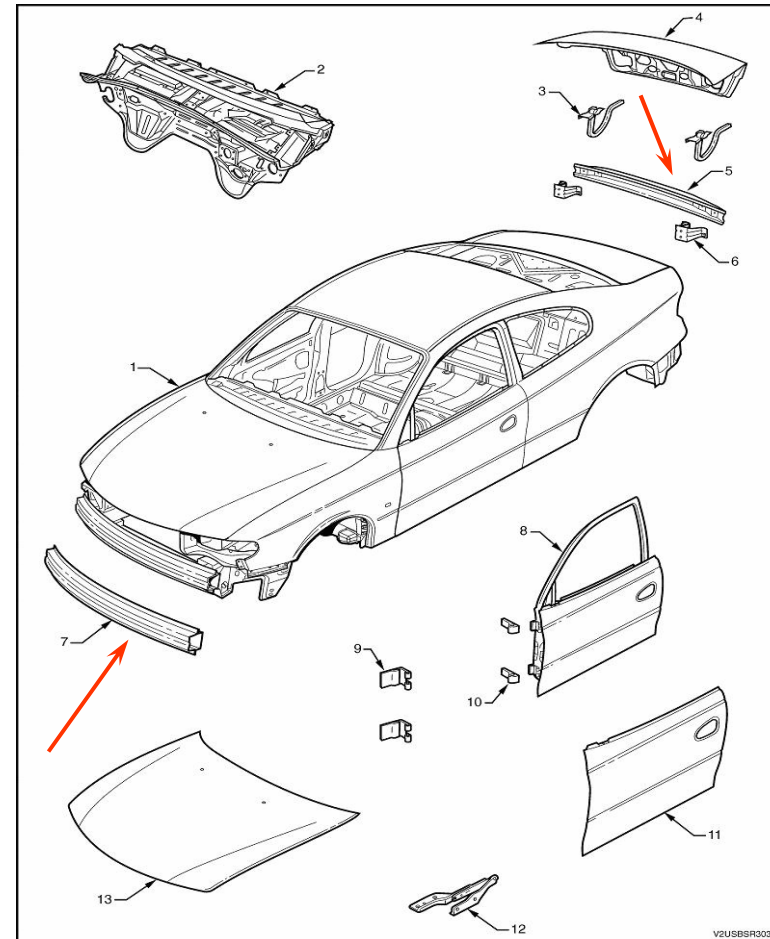

GTO Body Plate Information:

- Located on core support above left headlamp

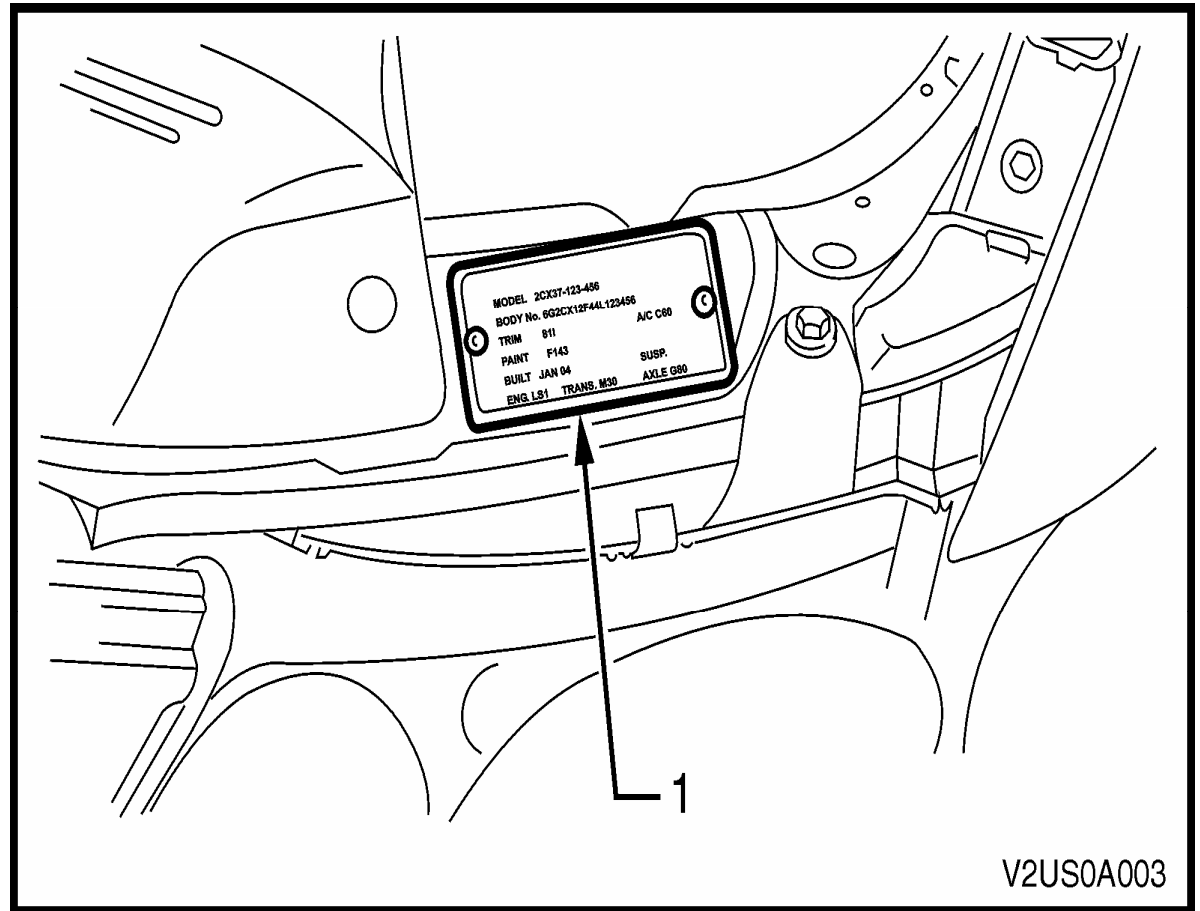

V2US0A003

GM

GTO Body Label Information:

Base/Clear
Technology

*WA #'s and
Service Manual
need corrections*

MODEL	2CX37	
BODY No.	6G2CX12F44L123456	
TRIM	81I	A/C C60
PAINT	F143	
BUILT	JAN 04	SUSP.
ENG. LS1	TRANS. M30	AXLE G80

V2US0A004



GTO Sealers, Adhesives and Foams:

Acoustic type
and locations:

- Use currently available field materials per GM TSB 02-08-98-003

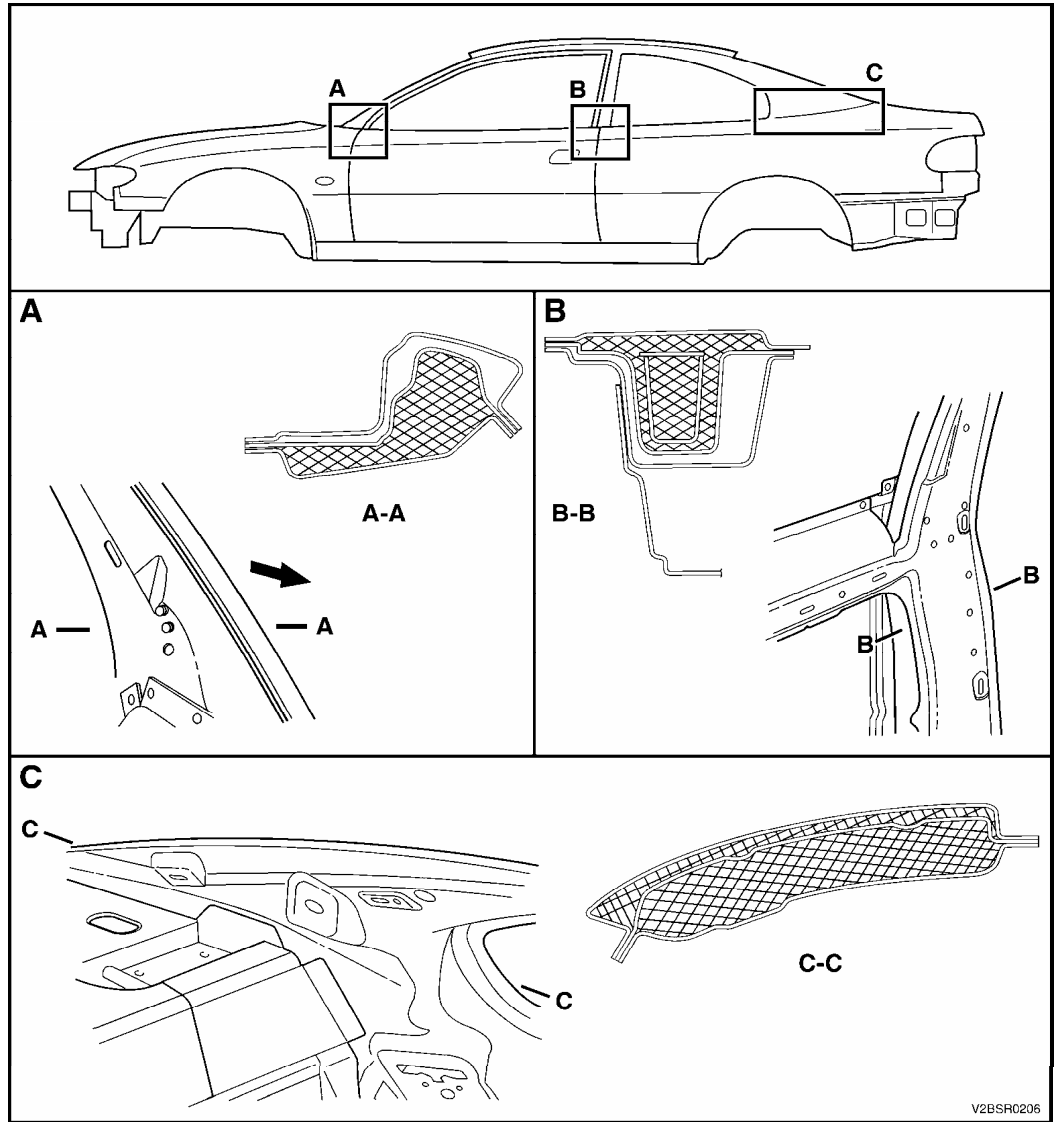



GTO Sealers, Adhesives and Foams:

Structural foam
areas:

- Service parts
come with material
installed

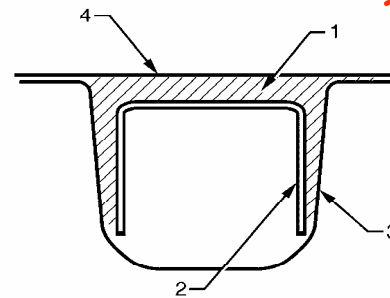
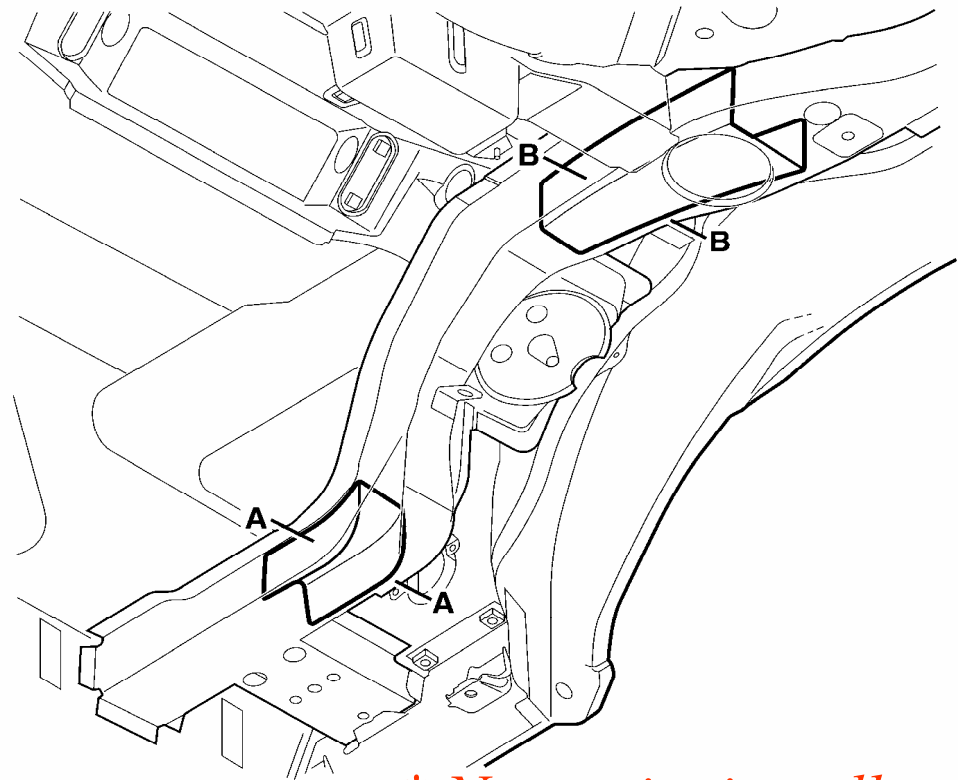

** No sectioning allowed*

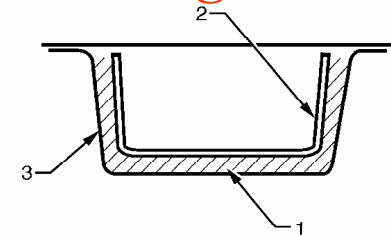

Collision Industry Conference – April 2004



GTO Frame and Underbody Dimensions:

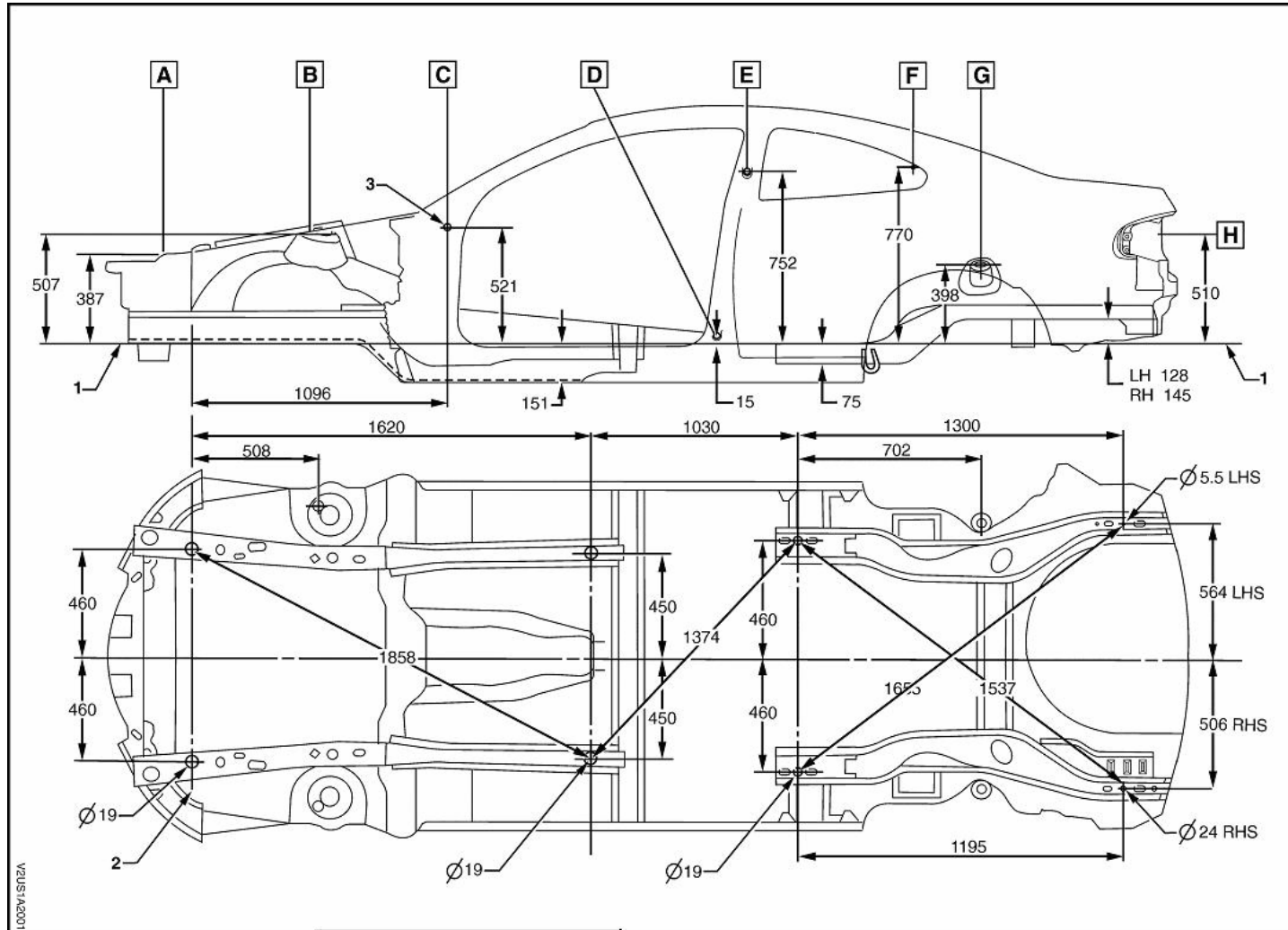

GTO Upper Body Dimensions:

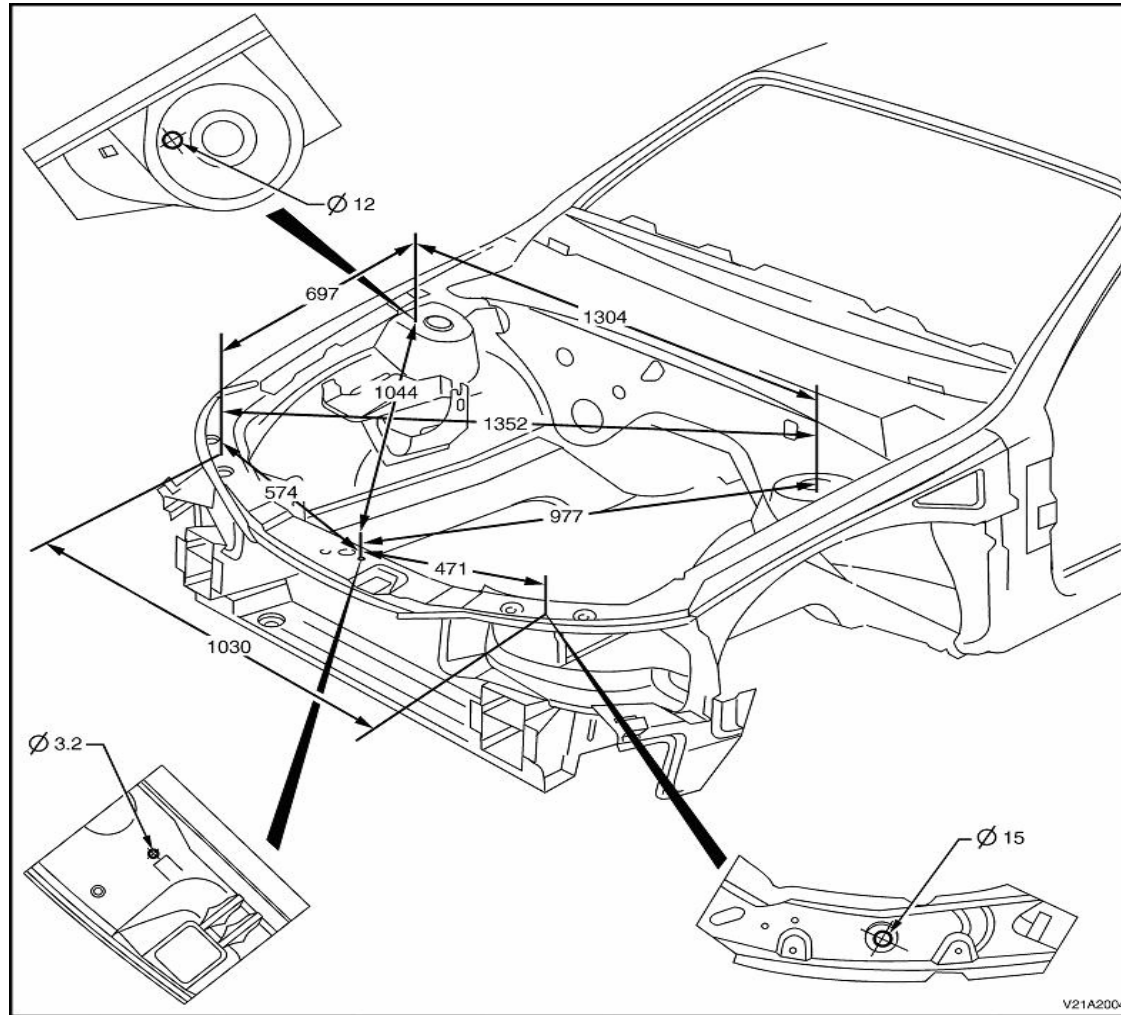



GTO

Body Side

Dimensions:

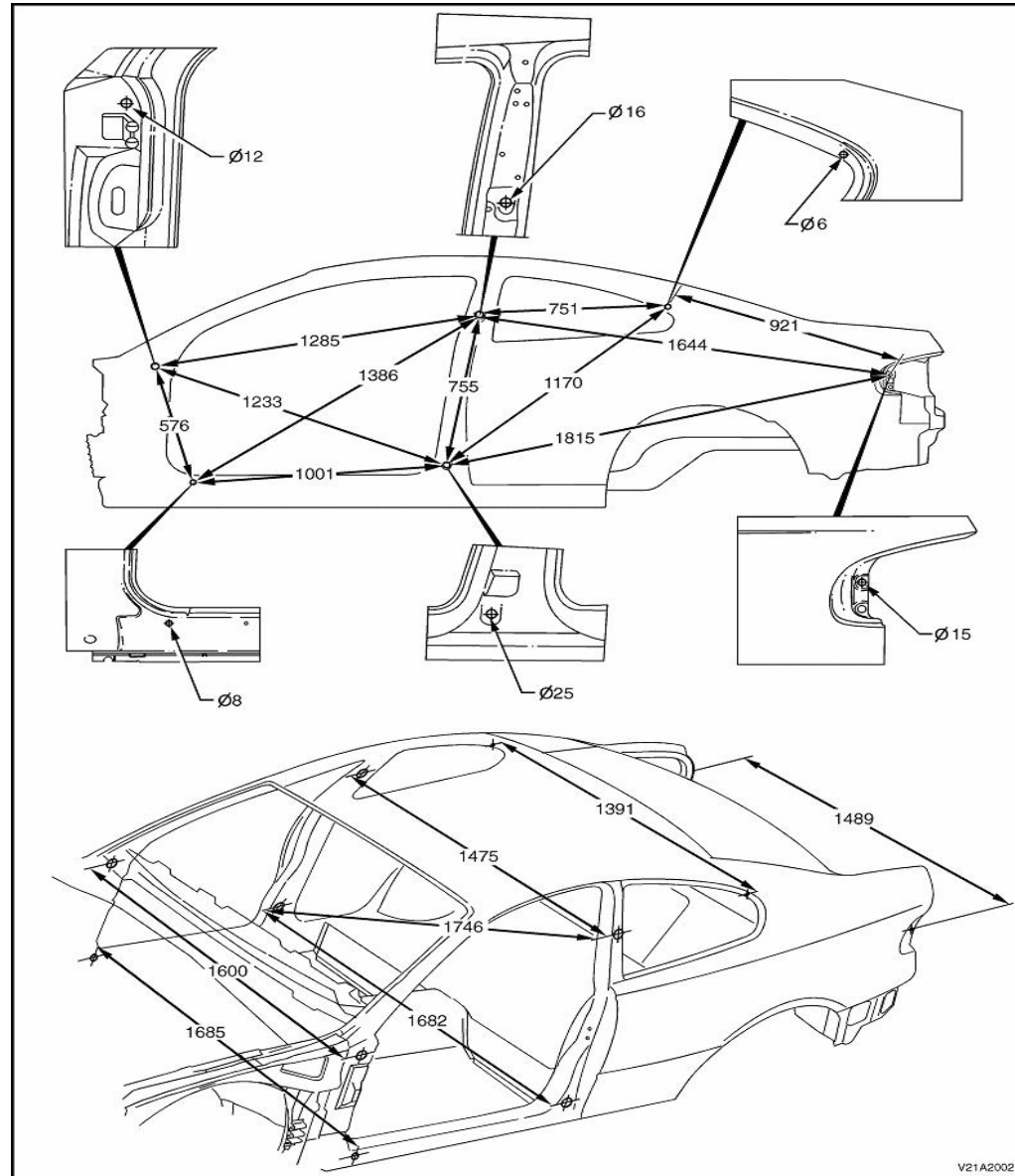

GM

GTO
Rear Body
Dimensions:

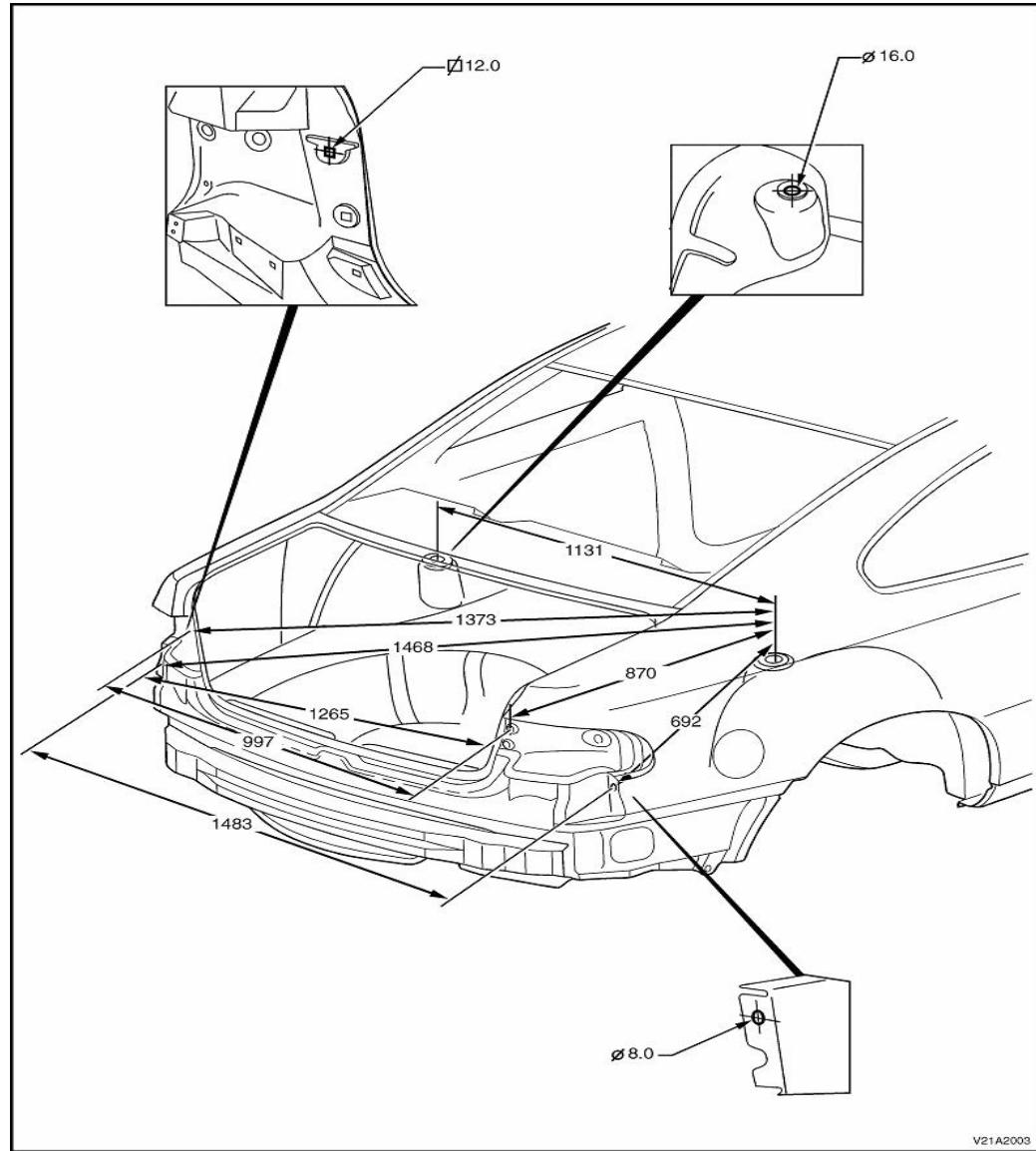

GTO SIR - Seat Belts:

SDM Location:

- Located on front floor section under center console

SIR – Seat Belt system:

- Driver and passenger
- Belt pre-tensioners
- No unique procedures

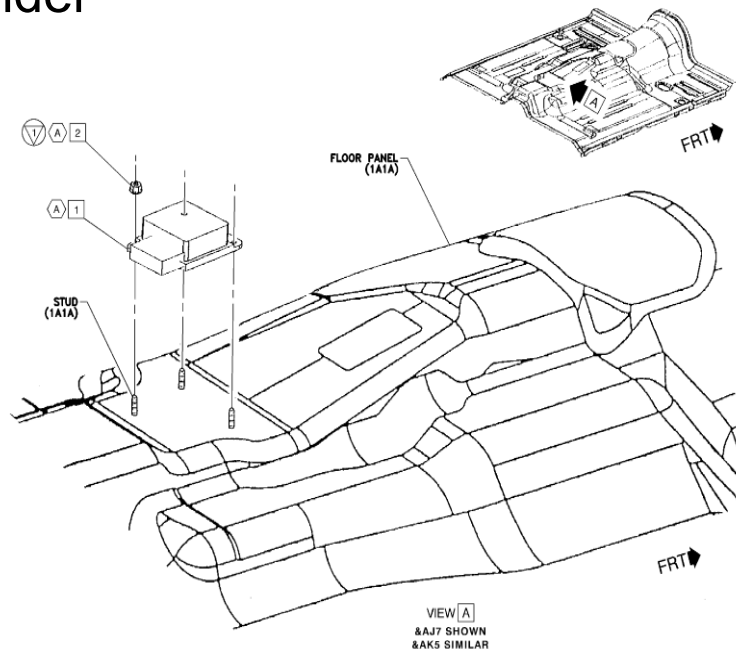



GTO Front Structure:

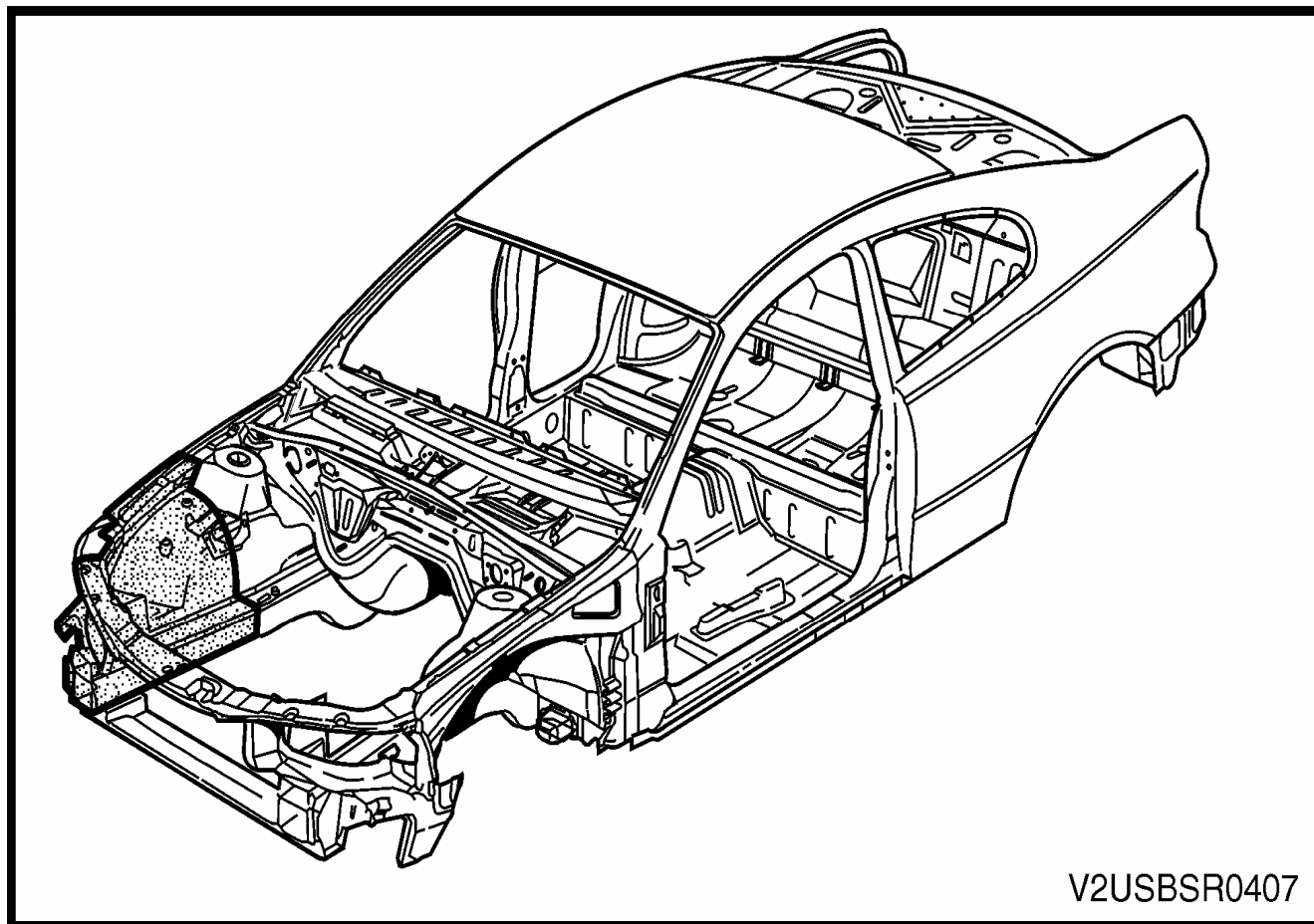

Front lower rail:

- “Step” cut the lower rail and “Butt-weld”

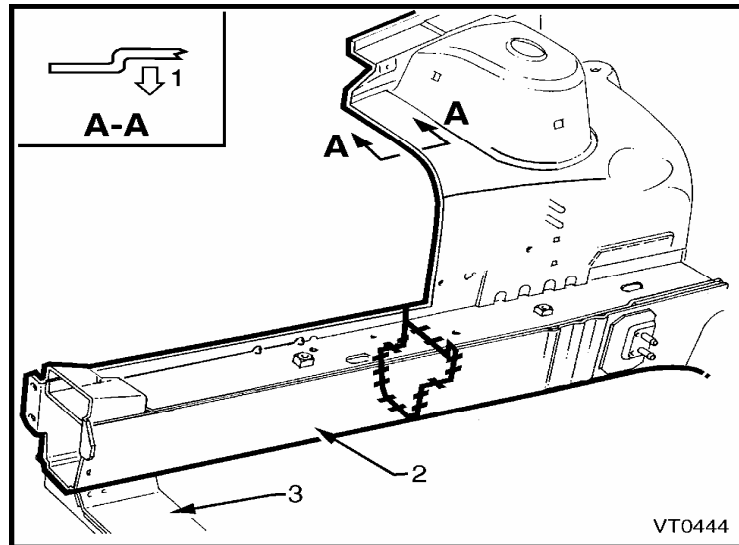

Front wheel house:

- Bend the cut edge to create a flanged overlap (“Joggle”)

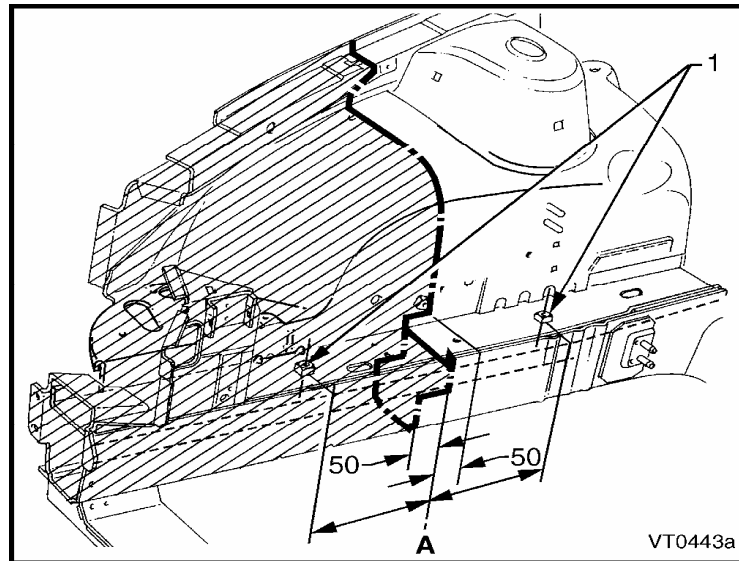



GTO Body Side Structure: (Sectioning)

Body Side Sectioning:

- Sectioning at various locations by amount of damage

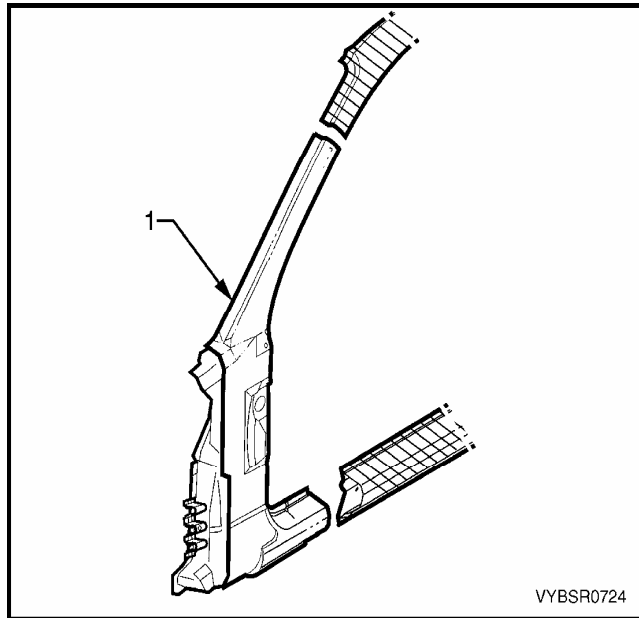

Front Body Hinge Pillar

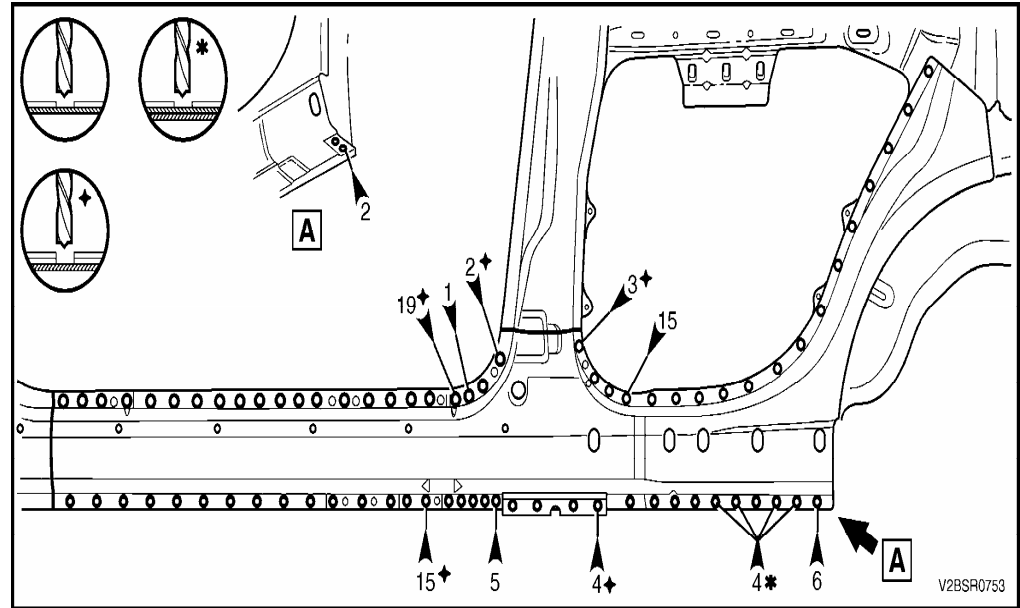

Rocker Panel

GTO Body Side Structure: (Sectioning)

Body Side Sectioning:

- Sectioning at specific locations

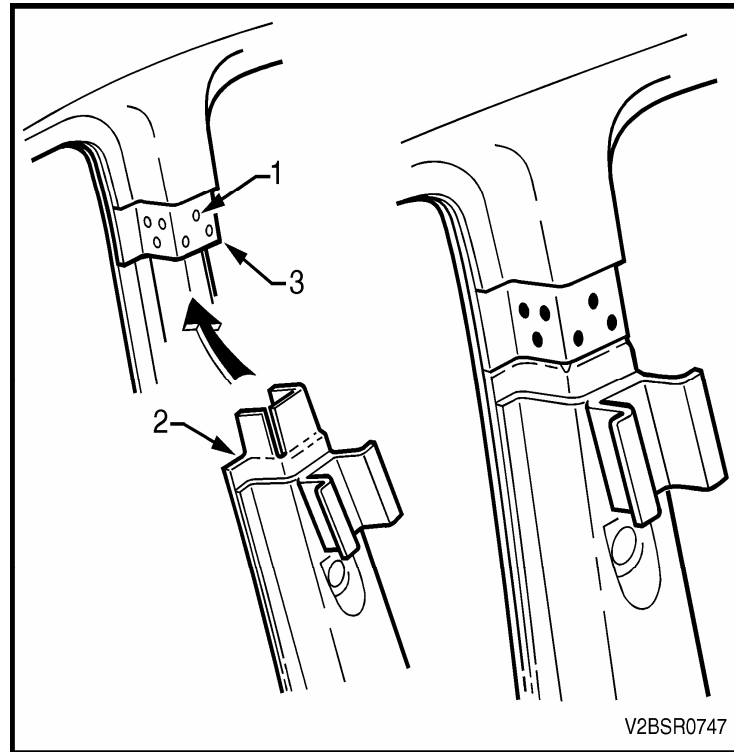
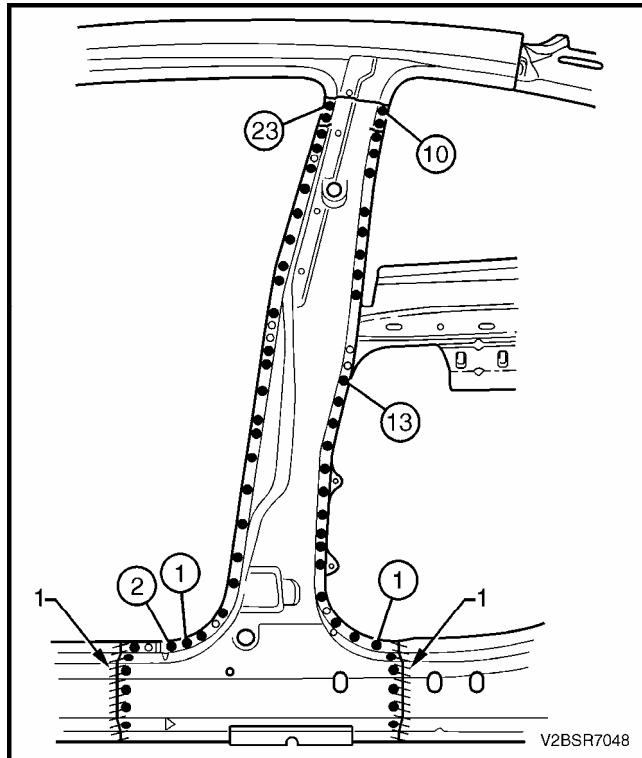

Center Pillar



GTO Structure: (Service Parts)

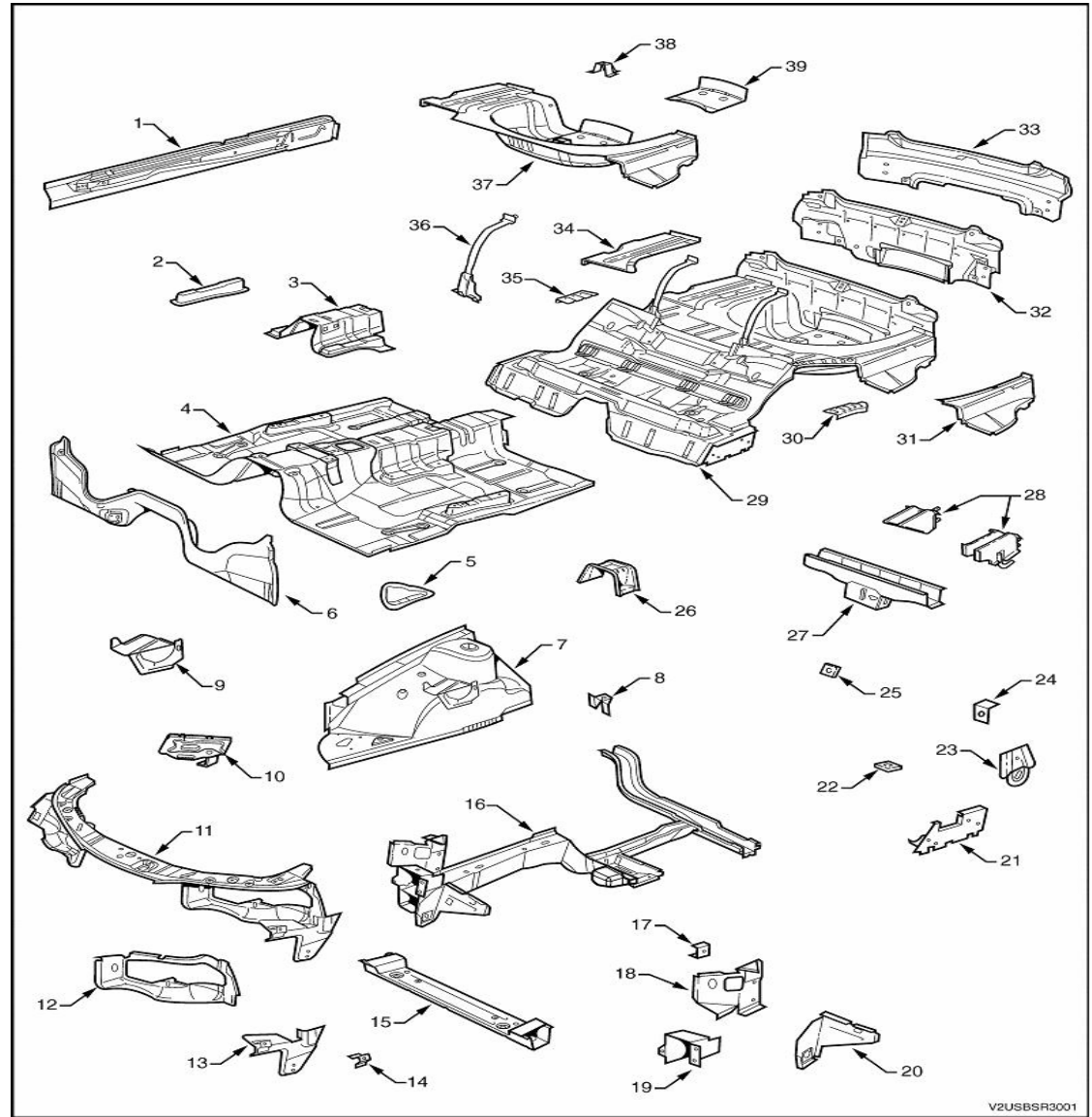



GTO Exterior Components: (Service Parts)

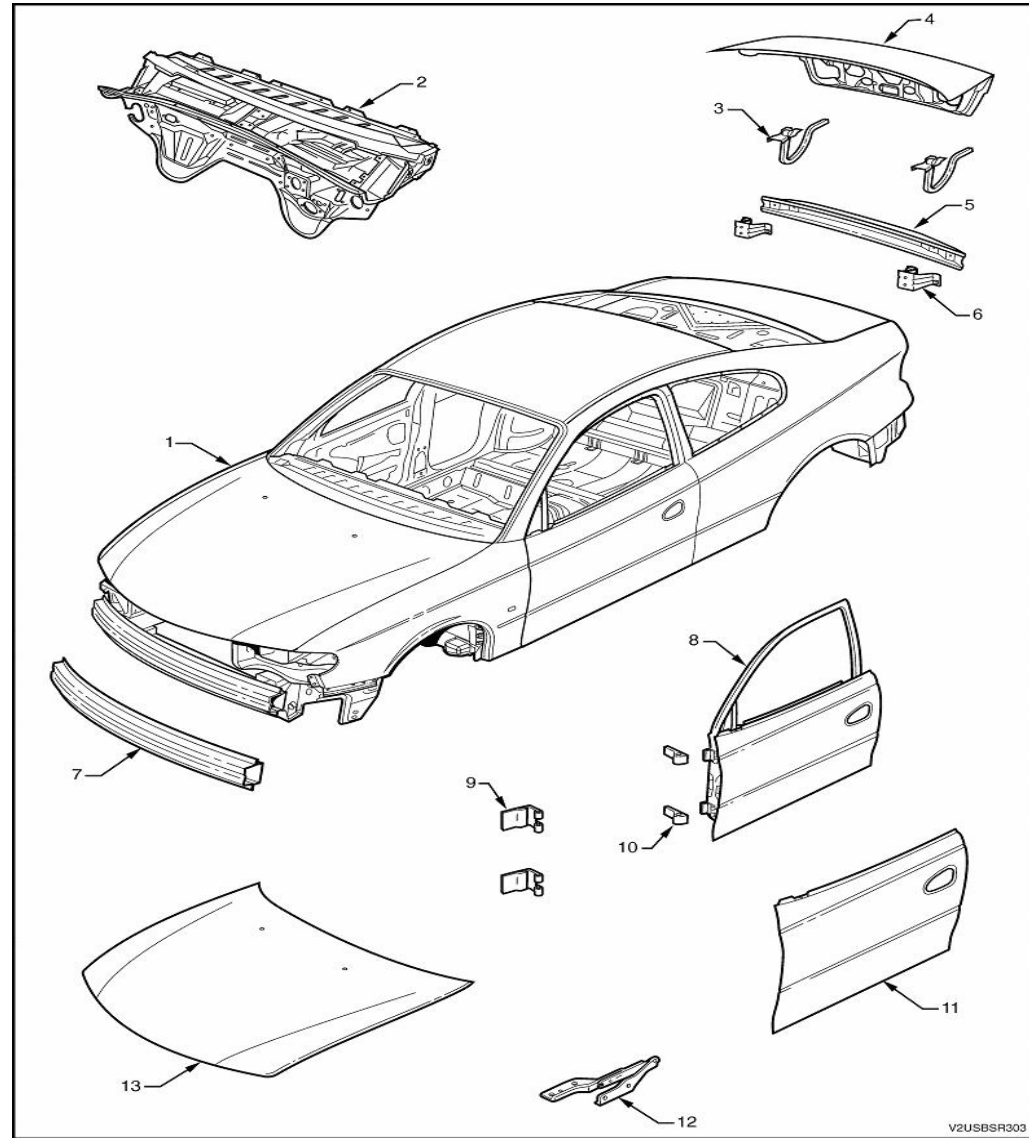



GTO Exterior and Inner Components: (Service parts)

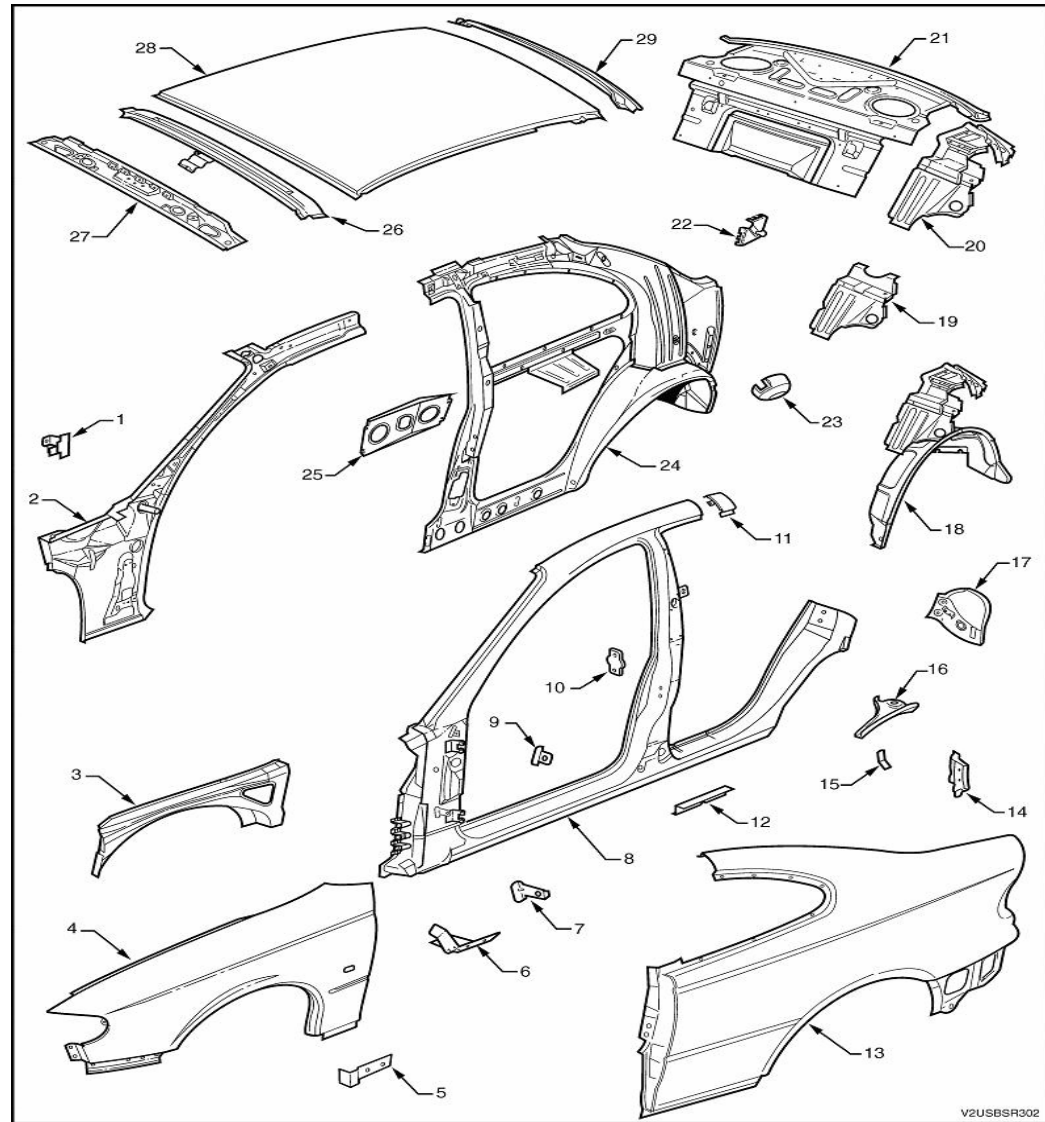

V2USBSR302



GTO Doors:

HINGES:

- Weld on
- Service and Adjustment using special tools

Sleeve Remover

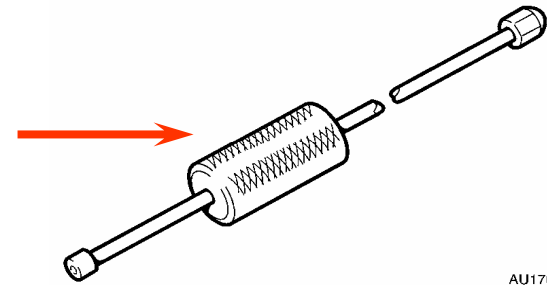

AU170

Hinge Setting Tool

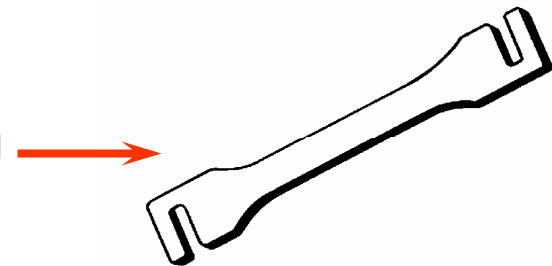

Sleeve Installer

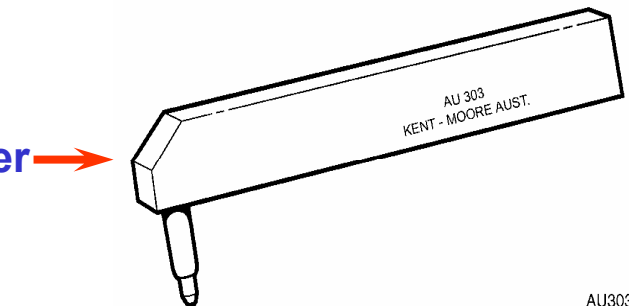

AU303



GTO Bumper System:

Front / Rear cover:

- Polypropylene
- Foam energy absorbers

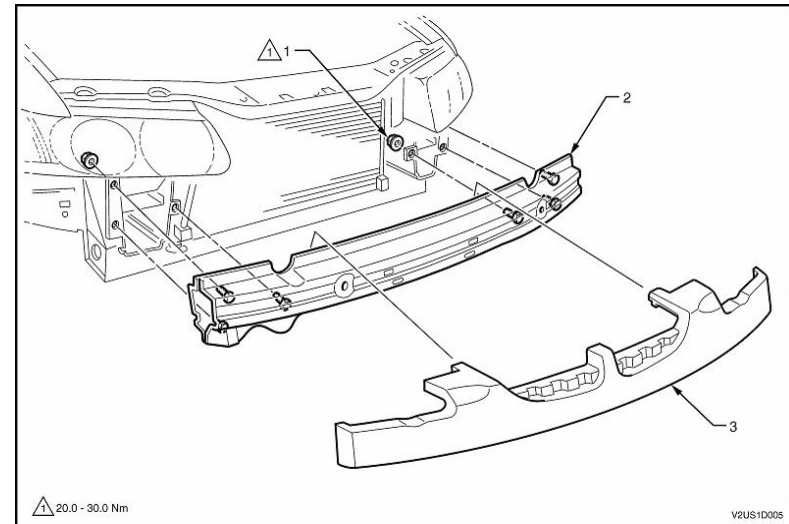

Front / Rear reinforcement bar:

- Bolt on components
- HSS – replace only

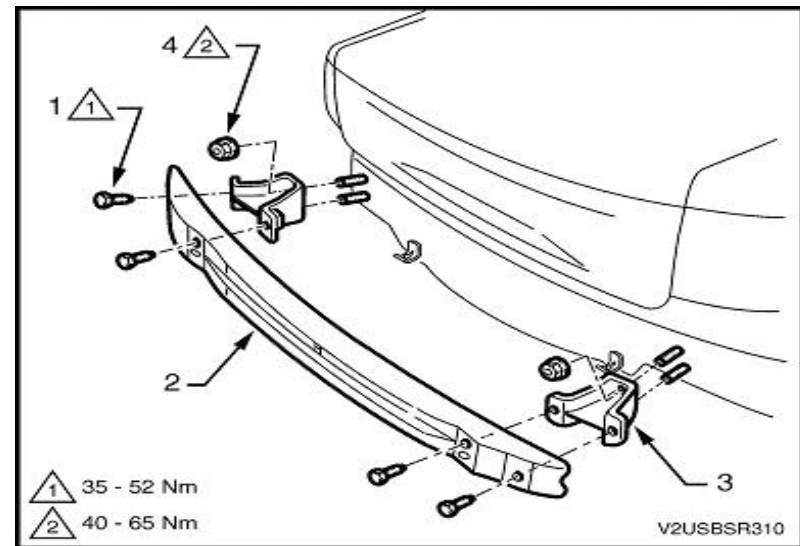

GM

GTO Lighting:

Headlamps:

- Halogen type bulbs
- Alignment by wall screen



Taillamps:

- Standard type bulbs (1157)



High Mounted Stop lamps:

- At spoiler and rear window
- Spoiler is L.E.D.

** Serviced as complete assembly / bulbs separately*

GM

GTO Body Moldings:

Rocker molding:

- Polypropylene



GM

GTO



2004 GTO